



## 204 St Margarets Court

Marina, Swansea, SA1 1RZ

Asking Price £125,000



## FULL DESCRIPTION

### ENTRANCE

Entrance via communal hall with stairs to first floor.

### HALLWAY

### CLOAKROOM

### LOUNGE/DINER

15'7" x 14'3" approx (4.77 x 4.35 approx)

### KITCHEN

9'4" x 7'8" (2.86 x 2.36)

### BEDROOM

11'7" x 11'5" approx (3.54 x 3.50 approx)

### ENSUITE

5'7" x 7'8" (1.72 x 2.36)

### PARKING

1 allocated parking space, also visitors permit parking.

### TENURE

125 years from 2005

Service charge - £1,582.92 pa or £131.91 pcm

Ground rent £100 pa

### UTILITIES

Electric - Yes

Gas - Yes

Water - Yes

You are advised to refer to Ofcom checker for mobile and broadband signal and coverage.

### COUNCIL TAX BAND - D

### EPC RATING - B

## AREA MAP



## FLOOR PLANS

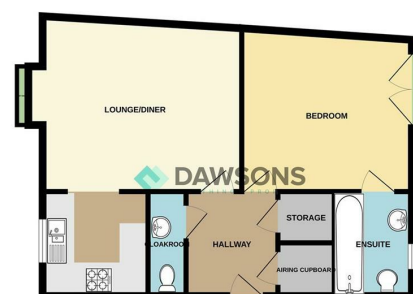

## EPC

Energy Efficiency Rating		Current	Potential
Very energy efficient - lower running costs			
(92 plus) A			
(81-91) B		81	82
(69-80) C			
(55-68) D			
(39-54) E			
(21-38) F			
(1-20) G			
Not energy efficient - higher running costs			
England & Wales		EU Directive 2002/91/EC	

These particulars, whilst believed to be accurate are set out as a general outline only for guidance and do not constitute any part of an offer or contract. Intending purchasers should not rely on them as statements or representations of fact, but must satisfy themselves by inspection or otherwise as to their accuracy. No person in this firm's employment has the authority to make or give any representation or warranty in respect of the property.



Unit A, Meridian Bay, Swansea, SA1 1PG

T 01792 653100 E sa1sales@dawsonsproperty.co.uk

W dawsonsproperty.co.uk

